

PORTE BATTANTES

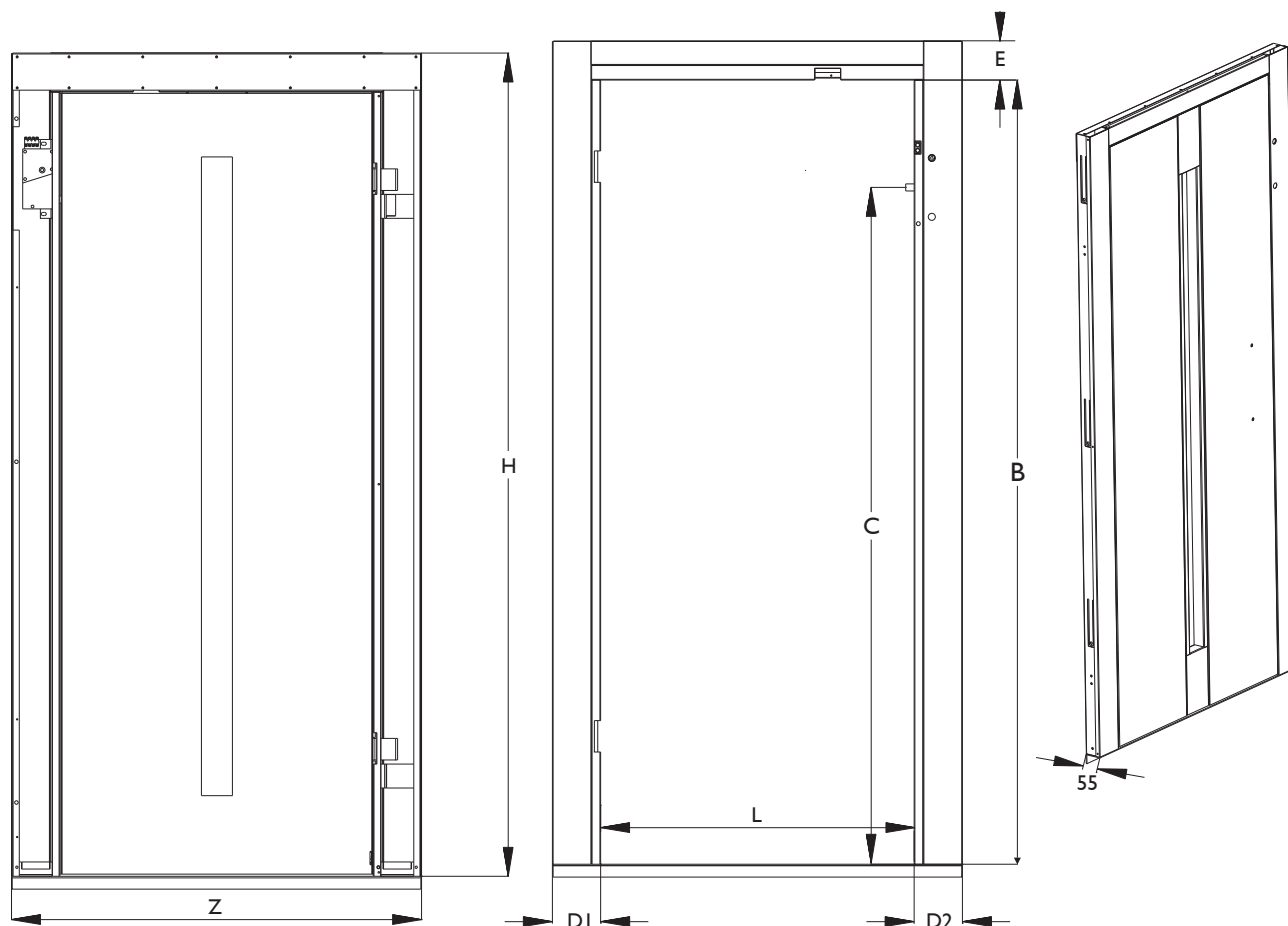

STA



Encadrement

L : Passage libre. 600, 650, 700, 750, 800, 850, 900, 1000 (mm)

D1 : Largeur montants standard. 80, 100, 120 (mm)

D2 : largeur montant de serrure 80, 100, 120 (mm)

Z : Largeur totale $Z=L+D1+D2$

B : Hauteur passage libre $B = 2m$

E : Linteau 100 ou 200 mm

H : Hauteur totale $H = B + E$

C : Hauteur serrure $C = 172$ mm

Ver. 01

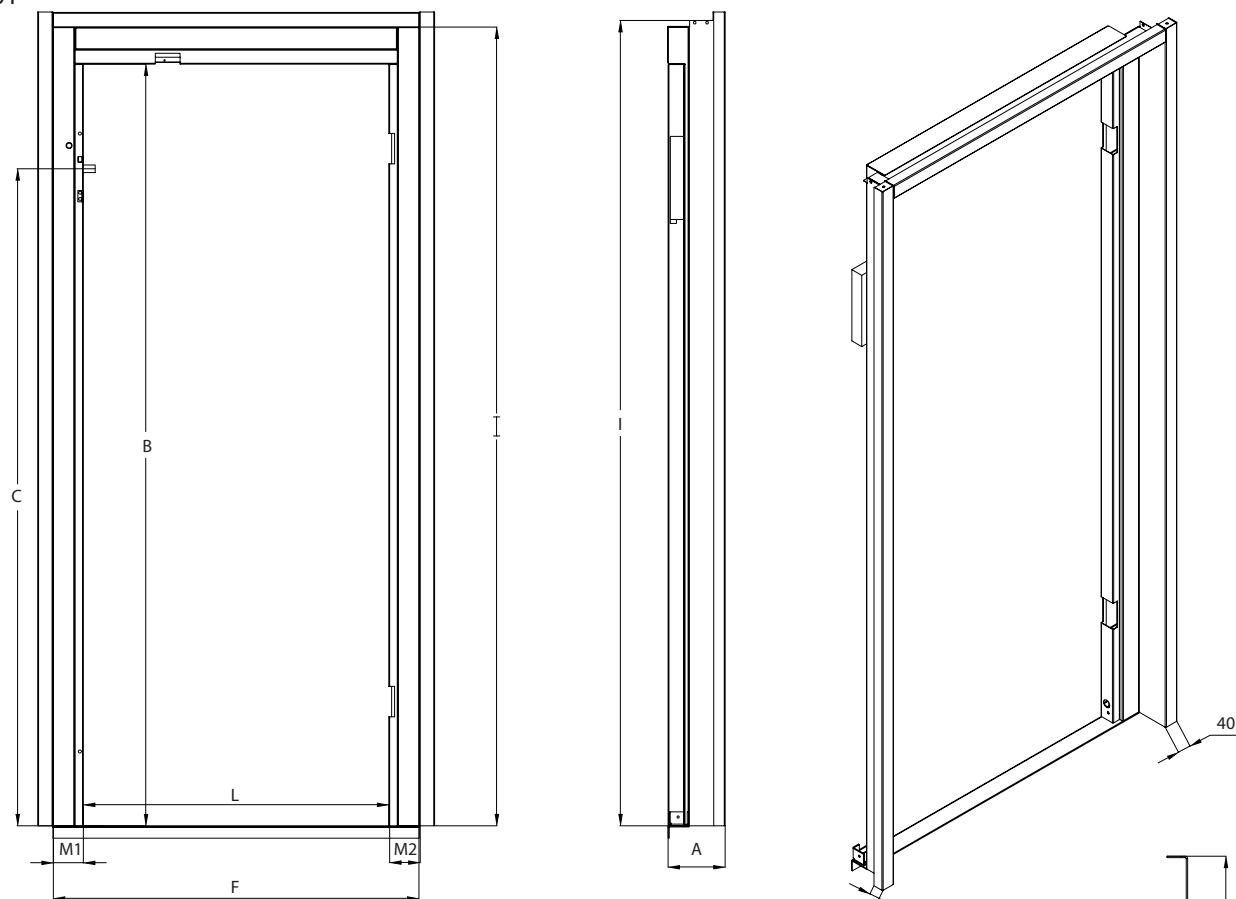

Encastrement

A : Largeur totale 150, 170, 191, 210 mm

L : Passage libre 600, 650, 700, 750, 800, 850, 900, 1000 mm

M1 : 80, 100, 120 mm

M2 : 80, 100, 120 mm

F : largeur totale (comprend le passage libre et son encombrement) **$F = L + M1 + M2$**

B : Hauteur libre **$B = 2000$ mm**

I : hauteur total (comprend le passage libre et son encombrement) **$I = 2100$ mm**

C : Hauteur serrure **$C = 17200$ mm**

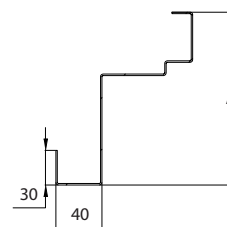

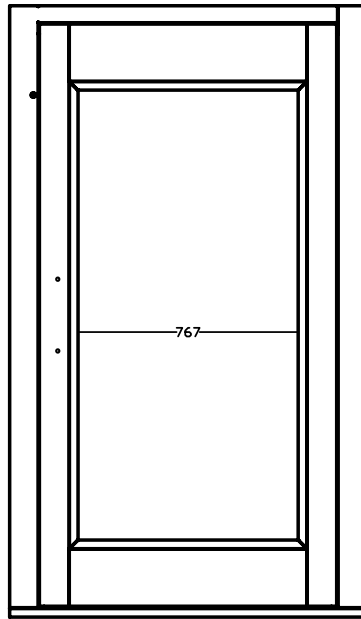

CD 1000

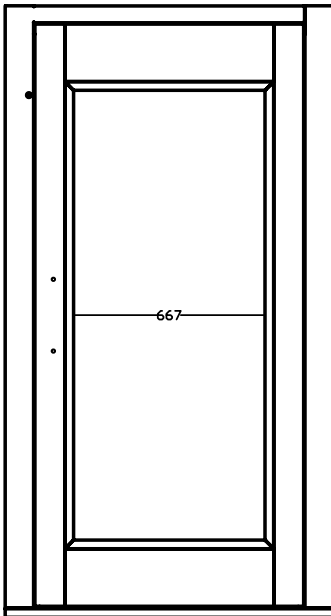

CD 900

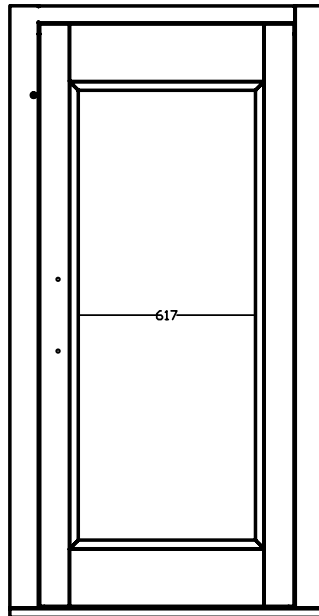

CD 850

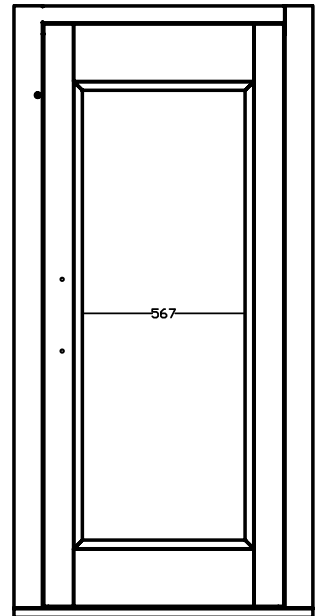

CD 800

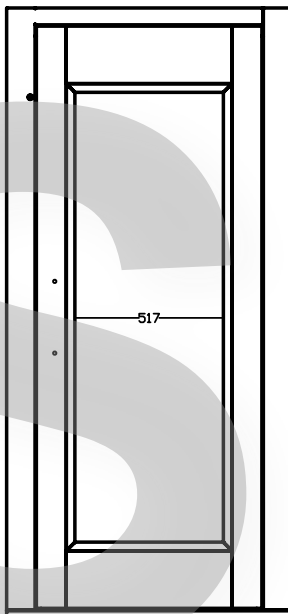

CD 750

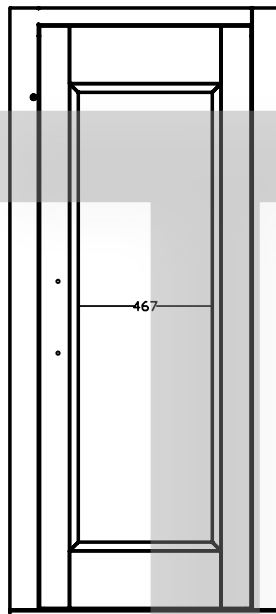

CD 700

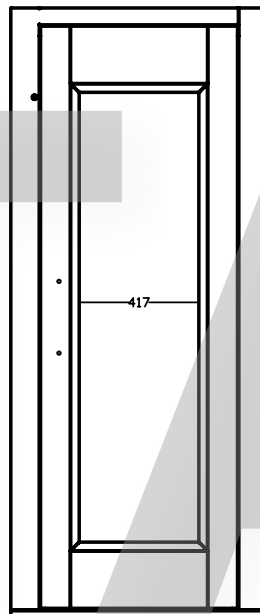

CD 650

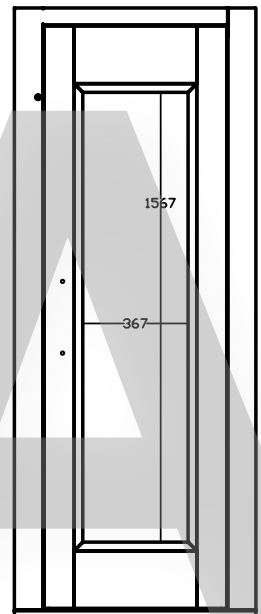

CD 600

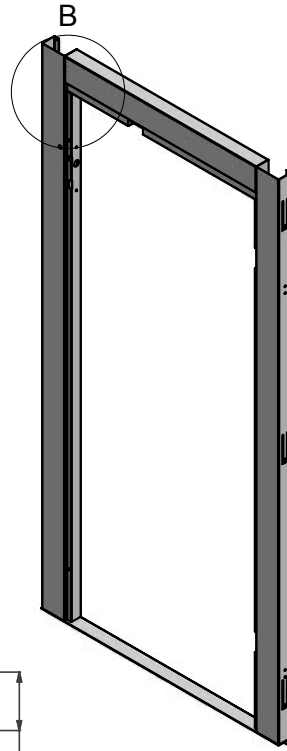

B (0,16 : 1)

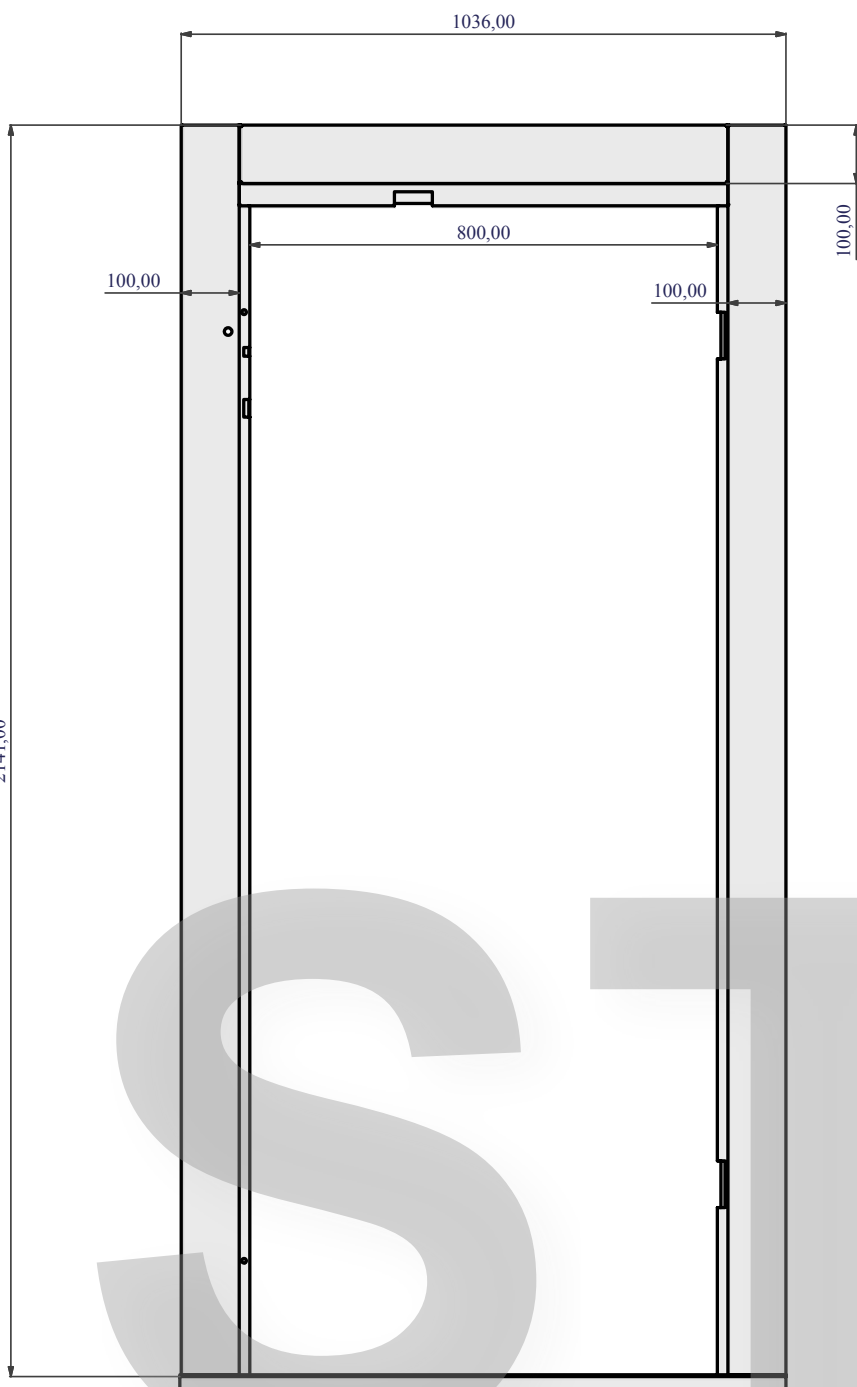
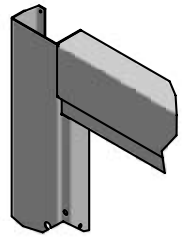

STA

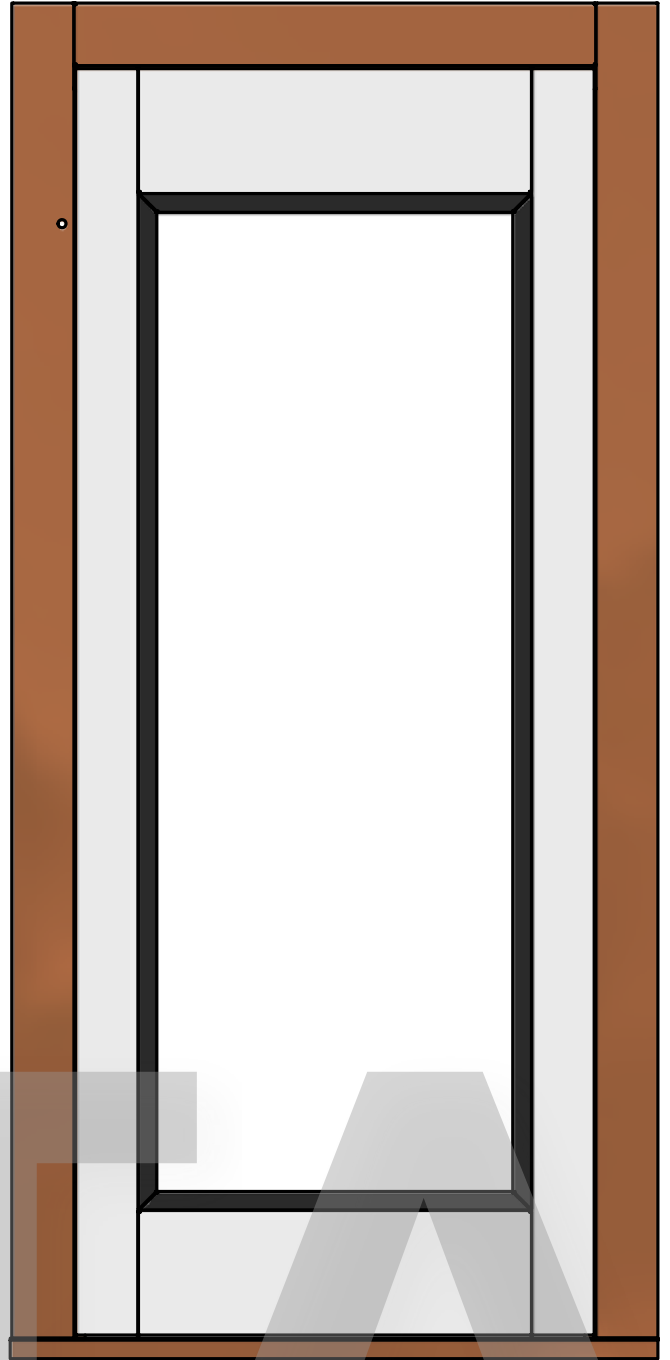
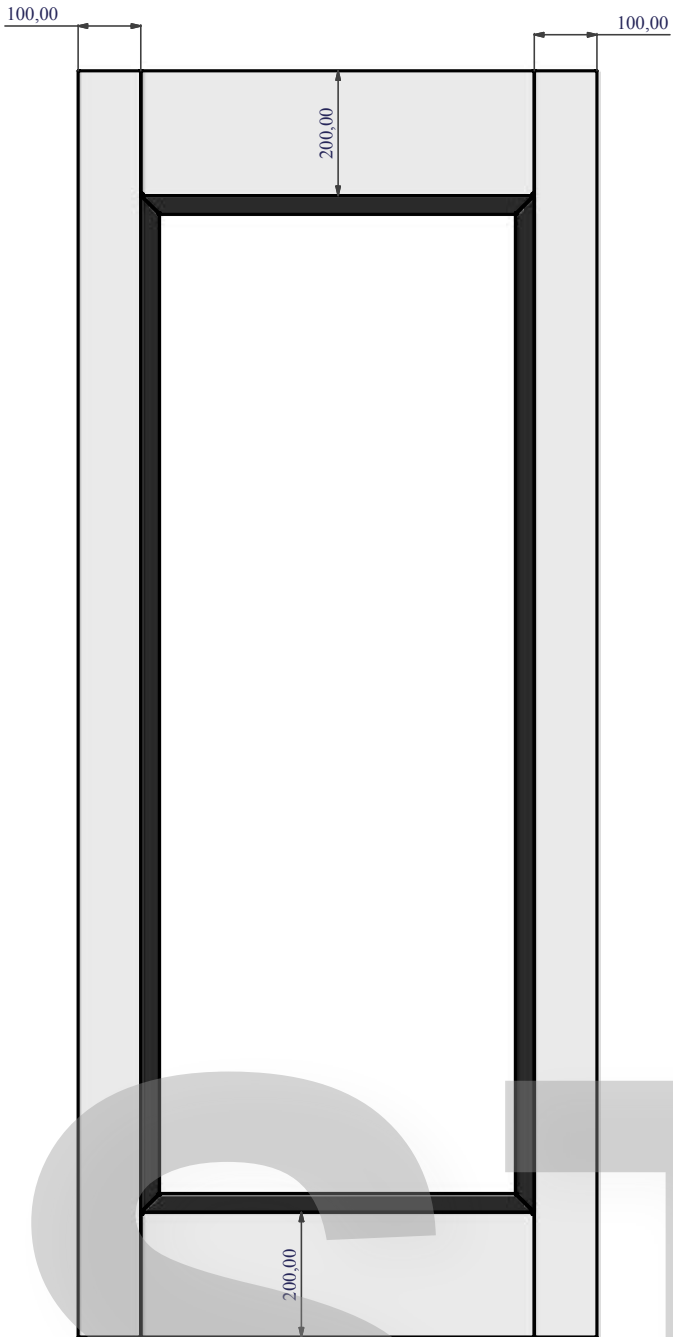

STA